

Series|TG4

Excavator weight class: up to 25 t
Wood loading grab

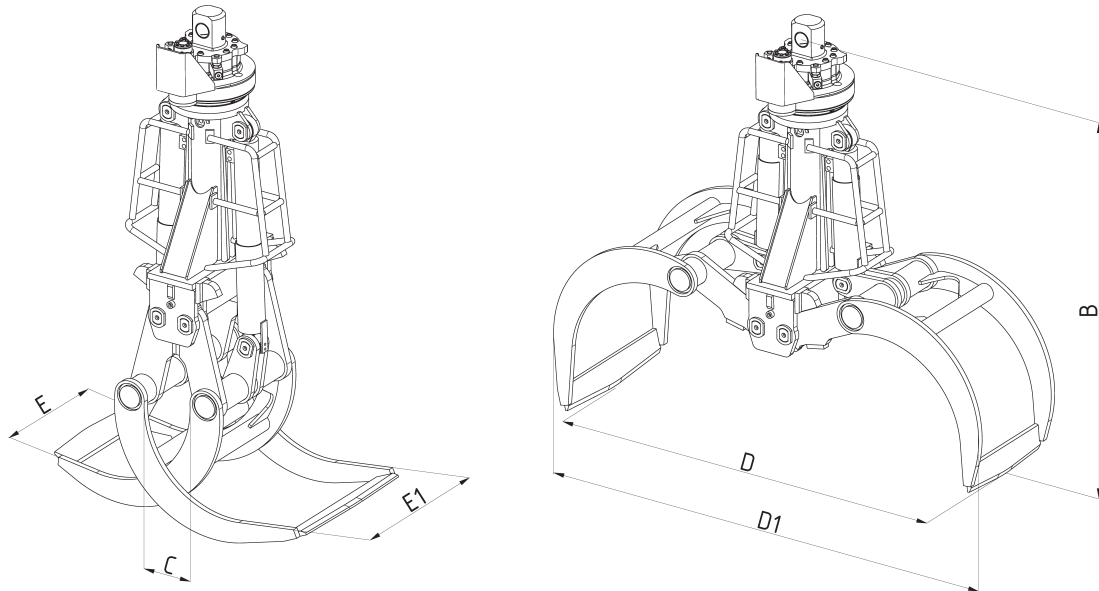

Type	Capa- city (m ²)	Weight (kg)	Width (mm) E / E1	max. log length (m)	Dimensions (mm)							
					A	B	C	d	D	E/E1	F	G
TG4-500-B	0.5	965	660/520	8	2460	2010	150	820	1820	1960	114	70
TG4-650-B	0.65	1015	660/520	6	2540	2050	150	900	1950	2090	114	70
TG4-800-B	0.8	1085	860/660	5	2710	2135	200	1050	2255	2415	114	70
TG4-1000-B	1.0	1145	860/660	3	2820	2190	210	1150	2445	2610	114	70

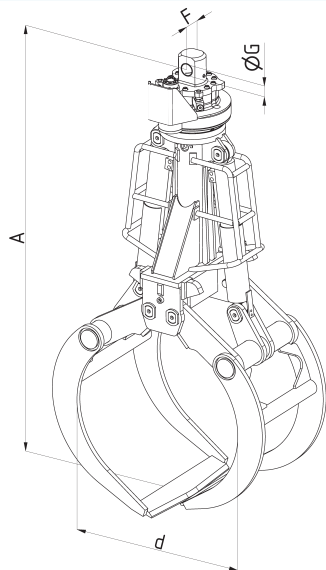

Technical specifications|TG4

Excavator weight class	t	up to 25
Max. grab load bearing capacity	t	Grab: 4 / slewing gear: 15
Max. operating pressure	bar	350 (grab function) / 140 (turning function)
Max. speed	RPM	12



|Use: Mobile and chain excavators

Orange peel grab for logs and round timber. Due to the shape of the tines, the TG4 wood grab can easily pick up one or more logs of different diameter from the ground, a stack or truck and confidently hold and handle them.



|Design features

- Continuously rotatable hydraulic compact rotary motor
- Complete grip made of high-strength fine-grained steel (HB 450)
- Flat, compact design
- Hose protective plate for the hydraulic connections on the slewing gear
- The hydraulic lines and synchronized control run protected in the arm

|Available accessories and equipment

- Hose set and mounting for all known excavator manufacturers
- Load hooks
- Customized and special shells according to customer specifications
- Additional special equipment upon request